

Chest freezer

SF-PC697(EX)-BF

-20°C

Thailand



Effective capacity
164L

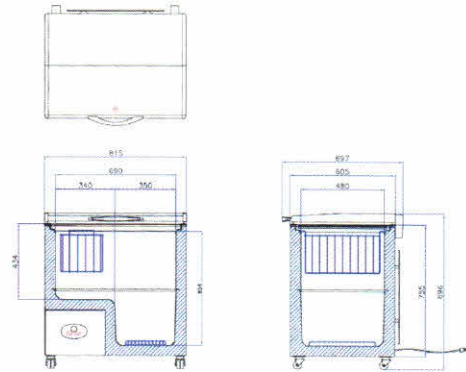

Model		SF-PC697(EX)-BF							
Operating temperature		-20°C (ambient temperature 32°C)							
Case body	Dimensions (mm)		W	D	H	Refrigeration system	Compressor	Hermetic type	
		External	815	697	896		Refrigerant	R134a	
	Internal	690	480	654	Evaporator		Copper tube wrapped on inner liner		
	Effective capacity (L)	164			Condenser		Wire cond & Tube natural convection		
	Outer case material	Bake on acryl finish on steel sheet			Temperature control		Mechanical thermostat		
	Inner case material	HIPS & bake on acryl finish on steel sheet			Defrost type		Manual off-cycle defrost		
	Door type	Bake on acryl finish on steel sheet			Lighting	No			
	Basket	PE powder coated basket x 1			Weight (kg)	49			
						Electrical parameter	Power source	Operation power	Defrost power
							1φ, 220V, 50-60Hz	ND	ND

Chest freezer

SF-PC900(EX)-BF

-20°C

Thailand



Effective capacity
236L

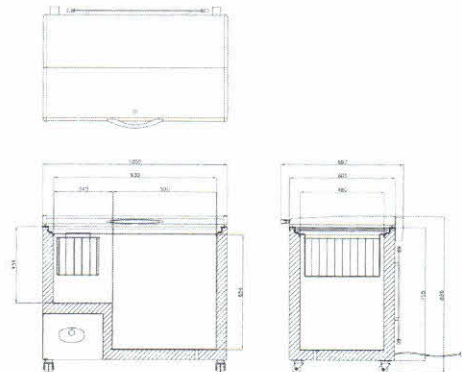

Model		SF-PC900(EX)-BF							
Operating temperature		-20°C (ambient temperature 32°C)							
Case body	Dimensions (mm)		W	D	H	Refrigeration system	Compressor	Hermetic type	
		External	1055	697	896		Refrigerant	R134a	
	Internal	930	480	654	Evaporator		Copper tube wrapped on inner liner		
	Effective capacity (L)	236			Condenser		Wire cond & Tube natural convection		
	Outer case material	Bake on acryl finish on steel sheet			Temperature control		Mechanical thermostat		
	Inner case material	Aluminum emboss sheet			Defrost type		Manual off-cycle defrost		
	Door type	Bake on acryl finish on steel sheet			Lighting	No			
	Basket	PE powder coated basket x 1			Weight (kg)	56.5			
						Electrical parameter	Power source	Operation power	Defrost power
							1φ, 220V, 50-60Hz	ND	ND